

## Profile

- Robust and economic plastic handwheel
- Hub made of zinc-coated steel for high stability and easy shaft mounting
- Various hub versions
- With thread for mounting a turning handle (see accessories)

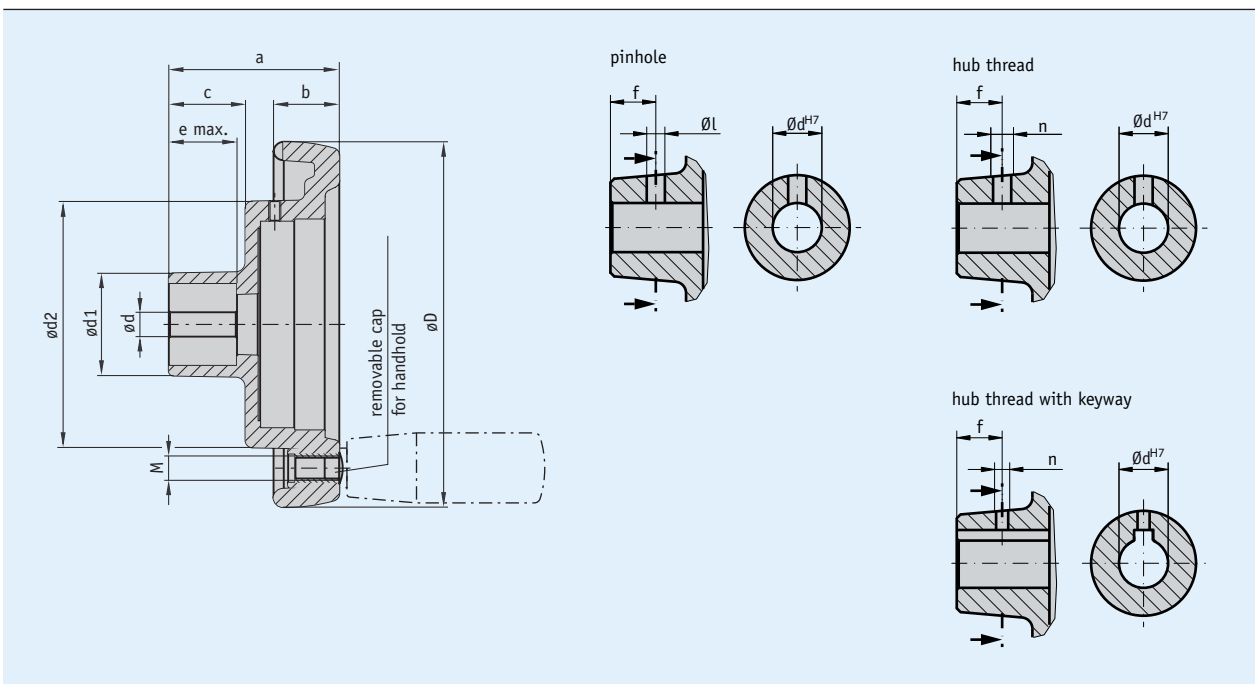

## Mechanical data

Feature	Technical data	Additional information
Material	plastic	hub of hot-dip steel
Weight	0.16 kg	KHB9

## Table of dimensions

Type	øD	ødv	ødx	ød1	ød2	a	b	c	e	GfG	Suitable for
KHB9	87	5.8	16	32	63	54	17	21	20	M6	S50/1

ødv = d prebored; ødx = d max.; GfG = Thread for handle

## Special treatment

Handwheel type	KHB9				
Bore dH7	6 ... 8	9, 10	11, 12	13, 14	15, 16
Groove width with keyway JS9		3	4		
Pin hole	3.8/8	3.8/8	3.8/8	4.8/8	
Hub thread without keyway JS9	M4/8	M4/8	M4/8	M6/8	
Hub thread with keyway JS9		M3/8	M3/8		

Texts highlighted in orange color are ordering features

## Order

### Ordering information

One or more system components are required:

Analog position indicator S50/1

[www.siko-global.com](http://www.siko-global.com)

### Ordering table

Feature	Ordering data	Specification	Additional information
Bore diameter	5.8	prebored	
	...	06 ... 16 mm, in steps of 1 mm	see Table of dimensions, maximum value ødx
Feather key groove	OP	without keyway	
	JS9	light seat	according to DIN 6885/1 T1
Pinhole	OS	without pin hole	
	...	diameter "ø"/measure "f" (e.g. 3.8/12)	see table Special processing, depending on the handwheel type, only if keyway is "OP", only if hub thread is "ONG"
		others on request	
Hub thread	ONG	without hub thread	
	...	thread "n"/measure "f" (e.g. M4/12)	see table Special processing, depending on the handwheel type, only if pin hole is "OS"
		others on request	
Position indicator	PM	position indicator mounted	separate ordering of a position indicator required!
	PS	position indicator separate	separate ordering of a position indicator required!
Tapered hub	OAN	without turned hub	
		others on request	

### Order key

KHB9 -  -  -  -  -  -

A      B      C      D      E      F

Scope of delivery: KHB9

#### Accessories you can find:

Handwheel holder BGF  
 Handwheel holder UG  
 Handwheel holder ZGD  
 Handwheel holder BGD  
 End Plate AD

[www.siko-global.com](http://www.siko-global.com)  
[www.siko-global.com](http://www.siko-global.com)  
[www.siko-global.com](http://www.siko-global.com)  
[www.siko-global.com](http://www.siko-global.com)  
[www.siko-global.com](http://www.siko-global.com)